

c:\users\eam\engineering\express\production - documents (1)\projects\23-68038 multiple products 2023 fbc update fl16355\work\drawings & cad\5-2-24 submittal\23-68038a - fl16355.1 - dwg 1.dwg

# CECO DOOR PRODUCTS

## DIVISION OF ASSA ABLOY DOOR GROUP, INC.

### CECO FLUSH PAIRS OF DOORS LARGE MISSILE IMPACT (LMI) - LEVEL "D" HVHZ

NON-SITE-SPECIFIC STRUCTURAL PERFORMANCE EVALUATION. A DESIGN PROFESSIONAL SHALL BE RESPONSIBLE FOR CERTIFYING THE APPLICATION OF THIS INFORMATION TO ANY SITE-SPECIFIC LOCATION.

**NOTE REGARDING USE OF THIS DOCUMENT & USE OUTSIDE FLORIDA:**

NON-SITE-SPECIFIC STRUCTURAL PERFORMANCE EVALUATION. THIS PRODUCT EVALUATION IS VALID FOR USE IN **FLORIDA ONLY**. USE OF THIS EVALUATION REQUIRES A REVIEW & CERTIFICATION BY A LOCAL DESIGN PROFESSIONAL WHO SHALL BE RESPONSIBLE FOR THE PROPER ADAPTATION OF THIS GENERAL PERFORMANCE EVALUATION TO ANY SITE-SPECIFIC PROJECT. CONTACT THIS OFFICE AT [ENGINEERINGEXPRESS.COM/QUOTE](http://ENGINEERINGEXPRESS.COM/QUOTE) FOR ASSISTANCE WITH YOUR PROJECT-SPECIFIC NEEDS & FOR ADAPTATION & CERTIFICATION OF THIS DOCUMENT OUTSIDE OF FLORIDA.

#### INSTRUCTIONS FOR USING THIS APPROVAL

**STEP 1:** USE THE DOOR ELEVATIONS PROVIDED ON PAGE 2 AND 3 TO DETERMINE THE APPLICABLE ASSEMBLY NUMBER

**STEP 2:** MOVE TO THE CHART BELOW THE DOOR ELEVATIONS, ALSO ON PAGE 2 AND 3, AND LOCATE YOUR ASSEMBLY NUMBER. BY SCANNING HORIZONTALLY THROUGH THE SAME ROW OF YOUR ASSEMBLY NUMBER, YOU WILL BE ABLE TO DETERMINE THE APPROVED **DOOR SERIES, MIN DOOR THICKNESS, MAX DESIGN PRESSURE, MAX DOOR OPENINGS, SWINGING OPTIONS, LATCHING HARDWARE FOR BOTH ACTIVE AND IN ACTIVE PANELS.**

**STEP 3:** USE PAGE 4 TO DETERMINE YOUR FRAMING PROFILES AND FRAMING CONSTRUCTION OPTIONS

**STEP 4:** USE THE TABLES ON PAGE 5 AND 6 TO DETERMINE THE ANCHOR TYPE AND SPACING, BASED ON THE YOUR PRESSURE AND SUBSTRATE CRITERIA

**STEP 5:** USE THE DETAILS PROVIDED ON PAGE 7 AND 8 TO DETERMINE YOUR WEATHERSTRIPPING OPTIONS

#### SHEET INDEX

# SHEET	DESCRIPTION
1	COVER SHEET
2-4	ASSEMBLY OPTIONS
5	DOOR FRAME DETAILS
6-7	DOOR FRAME ANCHORING INFORMATION
8-9	DOOR FRAME WEATHER STRIPPING INFORMATION
10	MANUFACTURERS AND ENGINEERING NOTES
10	TOTAL

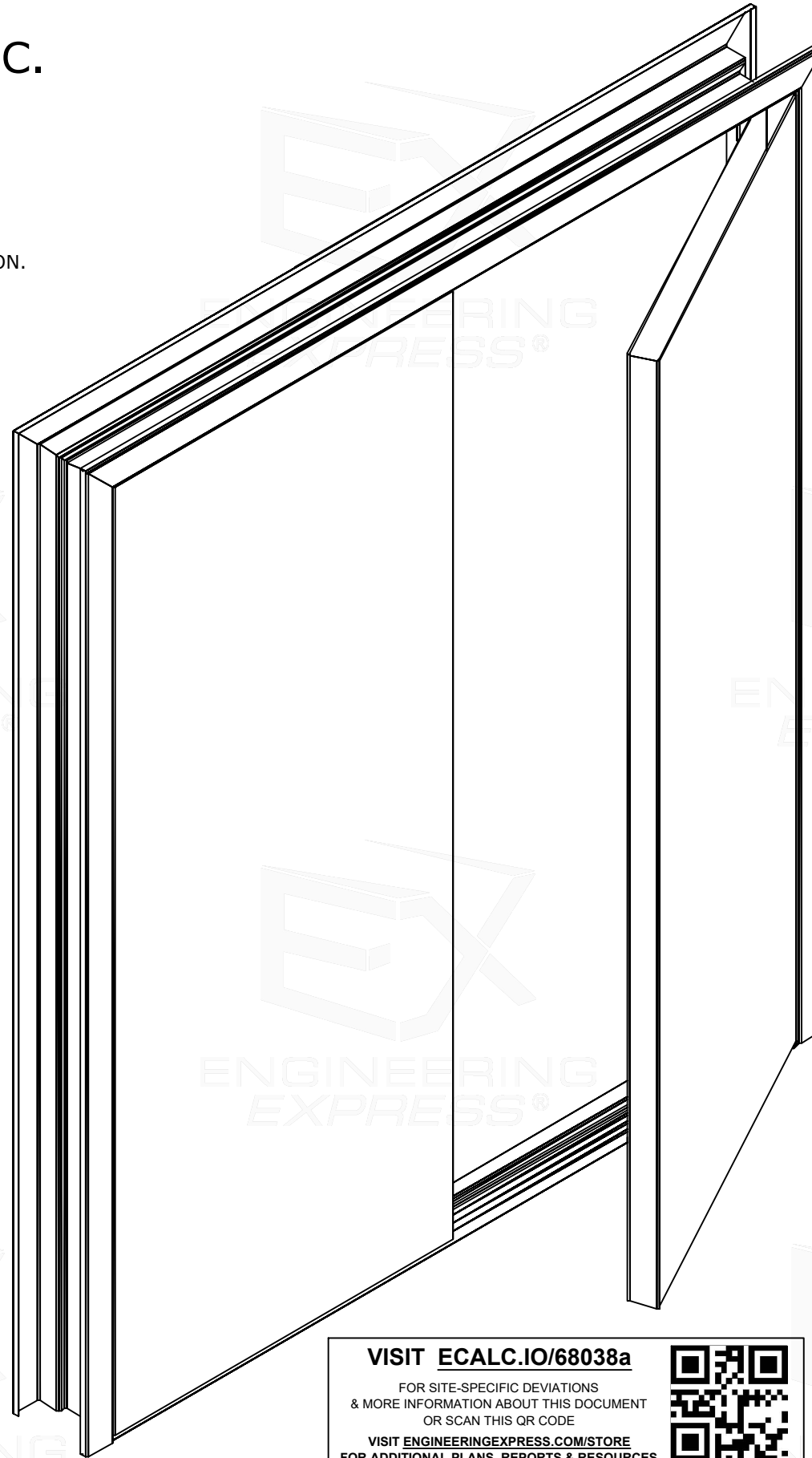

FRANK BENNARDO, PE  
PE# 0046549 CA# 9885

FL# 16355.1



POSTAL ADDRESS:  
2234 NORTH FEDERAL HWY #7664  
BOCA RATON, FL 33431  
ENGINEERINGEXPRESS.COM

**CECO DOOR PRODUCTS**  
DIVISION OF ASSA ABLOY DOOR GROUP, INC.  
9159 TELECOM DRIVE  
MILAN, TN 38358



COMMERCIAL STEEL EXTERIOR DOORS  
FLUSH PAIRS OF DOORS (LMI) - FBC (2023)  
FLORIDA STATEWIDE APPROVAL (FSA FL#16355.1)

REMARKS	DRWN	CHKD	DATE
INIT ISSUE (12-CUI-03g-01)	KL	FLB	06/28/13
FBC UPDATE	RWN	CSL	06/12/15
2017 FBC UPDATE	JEM	FLB	10/03/17
2020 FBC UPDATE	TAE	FLB	12/17/20
2023 FBC (PREV 20-34867)	AMZ	RS	10/18/23

COPYRIGHT ENGINEERING EXPRESS®

23-68038a

SCALE: NTS UNLESS NOTED

01 OF 10

VISIT [ECALC.IO/68038a](http://ECALC.IO/68038a)

FOR SITE-SPECIFIC DEVIATIONS & MORE INFORMATION ABOUT THIS DOCUMENT OR SCAN THIS QR CODE  
VISIT [ENGINEERINGEXPRESS.COM/STORE](http://ENGINEERINGEXPRESS.COM/STORE) FOR ADDITIONAL PLANS, REPORTS & RESOURCES



VISIT [ECALC.IO/assaabloy](http://ECALC.IO/assaabloy)

FOR HELPFUL RESOURCES, SITE SPECIFIC JOB ORDERING & MORE INFORMATION ABOUT THIS PRODUCT & RELATED SERVICES



ASSA ABLOY, the global leader in door opening solutions.

c:\users\eam\engineering\express\production - documents (1)\projects\23-68038 multiple products 2023 fbc update fl16355\work\drawings & cad\5-2-24 submittal\23-68038a - fl16355.1 - dwg 1.dwg

# CECO DOOR FLUSH PAIRS DOORS

PRODUCTS ILLUSTRATED IN THIS DOCUMENT ARE QUALIFIED FOR LARGE AND SMALL MISSILE IMPACT. LARGE MISSILE IMPACT IS 9 LB 2 X 4 AT 50 FEET PER SECOND OR 350 FT-LBS. (MISSILE LEVEL D) PRODUCT MEETS REQUIREMENTS OF THE HIGH VELOCITY HURRICANE ZONE.

FRANK BENNARDO, PE  
PE# 0046549 CA# 9885

MAY 8, 2024

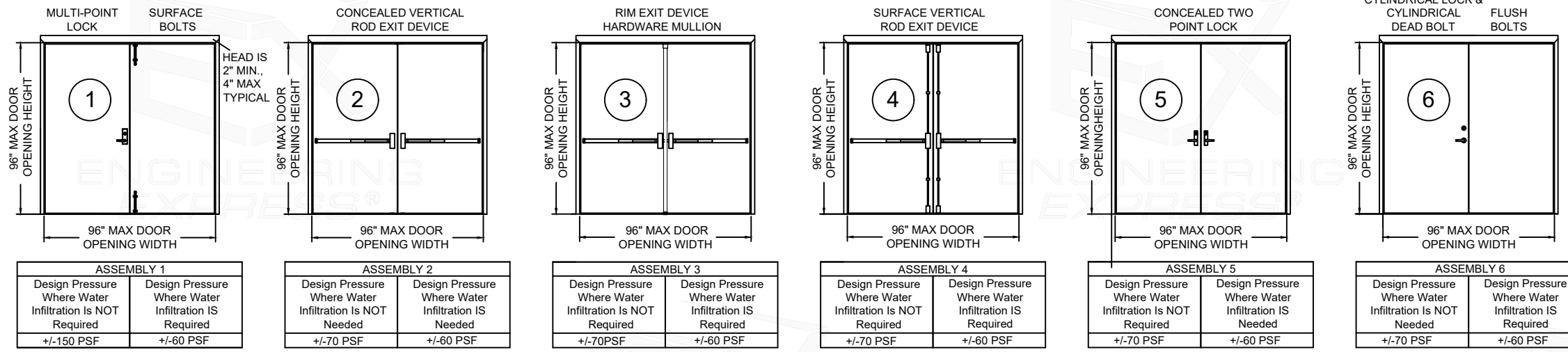

FL# 16355.1

**ENGINEERING EXPRESS**  
POSTAL ADDRESS:  
2234 NORTH FEDERAL HWY #7664  
BOCA RATON, FL 33431  
ENGINEERINGEXPRESS.COM

Assembly	Door Series	Minimum Door Gauge	Maximum Design Pressure (psf)		Maximum Door Opening (inches)		Door Swing	Latching Hardware Description Active			Latching Hardware Description In-Active		
			Positive	Negative	Width	Height		Type	Brand	Model	Type	Brand	Model
			①	Regent, Imperial	14	150		150	96	96 *	Out Swing or In Swing*	Multi-Point Lock	Corbin Russwin
②	Fuego, Medallion, Legion, Omega, Regent, Ultra, Trio, Trio-E	16 Trio, TrioE -18	70	70	96	96	Out Swing	Concealed Vertical Rod	Sargent	HC-MD-8600, HC-12-8600, HC-MD-12-8600, WS-MD-8600, WS-12-8600, WS-MD-12-8600	Concealed Vertical Rod	Sargent	988 HC-MD-8600, HC-12-8600, HC-MD-12-8600, WS-MD-8600, WS-12-8600, WS-MD-12-8600
③	Medallion, Legion, Omega, Regent, Ultra, Trio, Trio-E	16 Trio, TrioE -18	70	70	96	96	Out Swing	Rim Exit Device	Corbin Russwin	ED5200S(A) x M107	Rim Exit Device	Corbin Russwin	ED5200S(A) x M107
④	Medallion, Legion, Ultra, Regent, Omega, Trio, Trio-E	16 Trio, TrioE -18	70	70	96	96	Out Swing	Surface Vertical Rod	Sargent	HC4-8700	Surface Vertical Rod	Sargent	HC4-8700
⑤	Fuego, Imperial, Medallion, Legion, Omega, Regent, Ultra, Versadoor,	16 Trio, TrioE -18	70	70	96	96	Out Swing	Concealed Two Point Lock	ASSA ABLOY ACCENTRA	7150(F)WS/7250M(F)WS	Concealed Two Point Lock	ASSA ABLOY ACCENTRA	7150(F)WS/7250M(F)WS
⑥	Trio, Trio-E	18	70	70	96	96	Out Swing or In Swing*	Cylindrical Lock & Cylindrical Dead Bolt	Corbin Russwin	CL3100 DL3200 Dead Bolt	Flush Bolt	Rockwood	556WS
Hinges **	Butt	McKinney 4-1/2" x 4-1/2" 0.134" thick minimum steel hinges or any FBC approved butt hinges may be used. Any SDI member hinge locations may be used.											
	Continuous	Markar FM100, FM200, FM300, FM3500, FM100, FM1111, or HG305; Pemko CFMSLF-HD continuous hinges or any FBC approved continuous hinge may be used											
	Pivots	Rixon 195 Pivot set with M19 intermediate pivots may be used. Any FBC approved pivot may be used.											
Auxiliary Hardware	1" diameter and smaller preparations for door position switches, Door position switches that fit in a cutout measuring 1.25" x 4.875"; Securitron EPT, SEPT, and CEPT may be used. Maglocks may be used in addition to the hardware listed above. Viewers with 1" and smaller hole preparation may be used.												

**CECO DOOR PRODUCTS**  
DIVISION OF ASSA ABLOY DOOR GROUP, INC.  
9159 TELECOM DRIVE  
MILAN, TN 38358

**CecoDoor**  
**ASSA ABLOY**

COMMERCIAL STEEL EXTERIOR DOORS  
FLUSH PAIRS OF DOORS (LMI) - FBC (2023)  
FLORIDA STATEWIDE APPROVAL (FSA FL#16355.1)

REMARKS	DATE
INIT ISSUE (12-CUI-03g-01)	06/28/13
FBC UPDATE	06/12/15
2017 FBC UPDATE	10/03/17
2020 FBC UPDATE	12/17/20
2023 FBC (PREV 20-34867)	10/18/23

COPYRIGHT ENGINEERING EXPRESS®

\*In-Swing Configurations not approved for water infiltration. See Hardware notes for additional Hardware options.

\*\* SUBSTITUTIONS, WITH FBC COMPONENT APPROVALS, MAY BE USED AS LONG AS THE SUBSTITUTIONS ARE WITHIN THE LIMITING DESIGN PARAMETERS OF THIS APPROVAL AND THE COMPONENT APPROVAL.

23-68038a

SCALE: NTS UNLESS NOTED

02 OF 10



# CECO DOOR FLUSH PAIRS DOORS

PRODUCTS ILLUSTRATED IN THIS DOCUMENT ARE QUALIFIED FOR LARGE AND SMALL MISSILE IMPACT. LARGE MISSILE IMPACT IS 9 LB 2 X 4 AT 50 FEET PER SECOND OR 350 FT-LBS. (MISSILE LEVEL D) PRODUCT MEETS REQUIREMENTS OF THE HIGH VELOCITY HURRICANE ZONE.

FRANK BENNARDO, PE  
PE# 0046549 CA# 9885

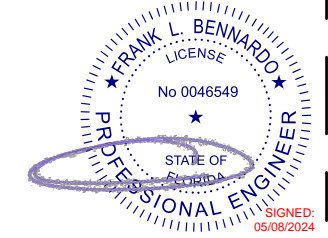

MAY 8, 2024

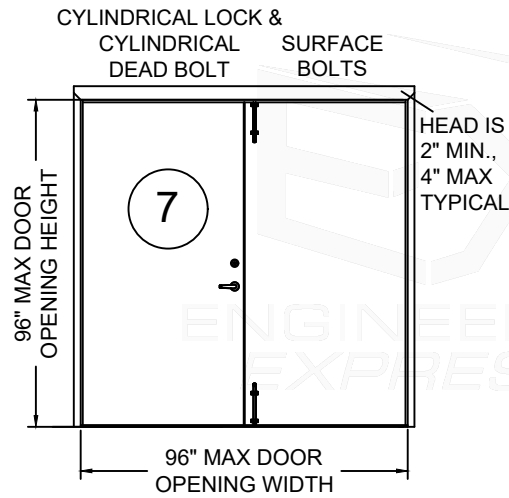

ASSEMBLY 7	
Design Pressure Where Water Infiltration Is NOT Required	Design Pressure Where Water Infiltration IS Required
+/-70 PSF	+/-60 PSF

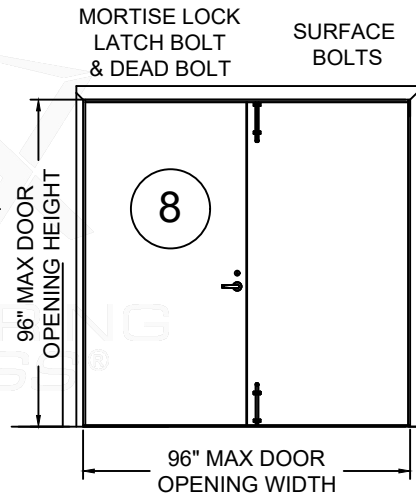

ASSEMBLY 8	
Design Pressure Where Water Infiltration Is NOT Required	Design Pressure Where Water Infiltration IS Required
+/-70 PSF	+/-60 PSF

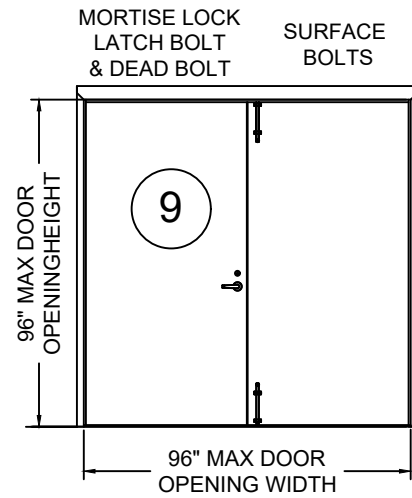

ASSEMBLY 9	
Design Pressure Where Water Infiltration Is NOT Required	Design Pressure Where Water Infiltration IS Required
+/-70 PSF	+/-60 PSF

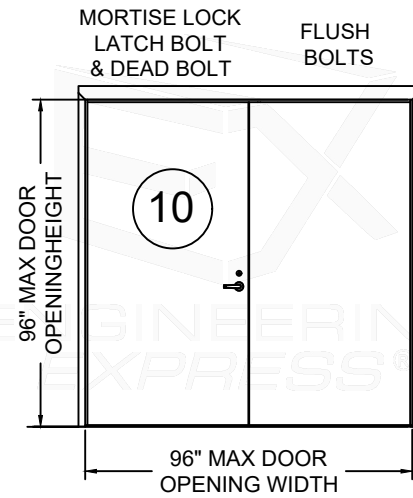

ASSEMBLY 10	
Design Pressure Where Water Infiltration Is NOT Required	Design Pressure Where Water Infiltration IS Required
+/-70 PSF	+/-60 PSF

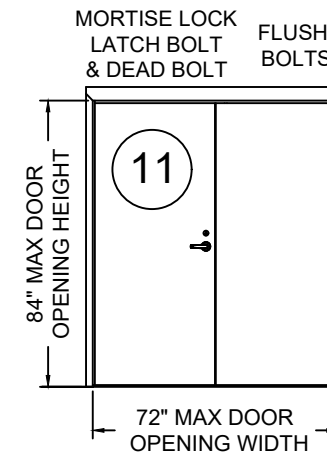

ASSEMBLY 11	
Design Pressure Where Water Infiltration Is NOT Needed	Design Pressure Where Water Infiltration IS Needed
+/-70 PSF	+/-60 PSF

FL# 16355.1

**ENGINEERING EXPRESS**  
POSTAL ADDRESS:  
2234 NORTH FEDERAL HWY #7664  
BOCA RATON, FL 33431  
ENGINEERINGEXPRESS.COM

Assembly	Door Series	Minimum Door Gauge	Maximum Design Pressure (psf)		Maximum Door Opening (inches)		Door Swing	Latching Hardware Description Active			Latching Hardware Description In-Active		
			Positive	Negative	Width	Height		Type	Brand	Model	Type	Brand	Model
7	Trio, Trio-E	18	70	70	96	96	Out Swing or In Swing*	Cylindrical Lock & Cylindrical Dead Bolt	Corbin Russwin	CL3100 DL3200 Dead Bolt	Surface Bolt	Corbin Russwin	988CR
								Sargent	11 Line 480 Dead Bolt	Sargent		988	
8	Fuego, Imperial, Medallion, Legion, Omega, Regent, Ultra, Versadoor	16	70	70	96	96	Out Swing	Mortise Lock Latch Bolt & Dead Bolt	Corbin Russwin	ML2000	Surface Bolt	Corbin Russwin	988CR
								Sargent	7800, 8200, R8200	Sargent		988	
								ASSA ABLOY ACCENTRA	8800	ASSA ABLOY ACCENTRA		988Y	
9	Trio, Trio-E	18	70	70	96	96	Out Swing or In Swing*	Mortise Lock Latch Bolt & Dead Bolt	Corbin Russwin	ML2000	Surface Bolt	Corbin Russwin	988CR
								Sargent	7800, 8200, R8200	Sargent		988	
								ASSA ABLOY ACCENTRA	8800	ASSA ABLOY ACCENTRA		988Y	
10	Trio, Trio-E	18	70	70	96	96	Out Swing or In Swing*	Mortise Lock Latch Bolt & Dead Bolt	Corbin Russwin	ML2000	Flush Bolt	Rockwood	556WS
								Sargent	7800, 8200, R8200				
								ASSA ABLOY ACCENTRA	8800				
11	Trio, Trio-E	18	70	70	72	84	Out Swing or In Swing*	Mortise Lock Latch Bolt & Dead Bolt	Corbin Russwin	ML2000	Surface Bolt	Corbin Russwin	988CR
								Sargent	7800, 8200, R8200	Sargent		988	
								ASSA ABLOY ACCENTRA	8800	ASSA ABLOY ACCENTRA		988Y	
Hinges**	Butt	McKinney 4-1/2" x 4-1/2" 0.134" thick minimum steel hinges or any FBC approved butt hinges may be used. Any SDI member hinge locations may be used.											
	Continuous	Markar FM100, FM200, FM300, FM3500, FM100, FM1111, or HG305; Pemko CFMSLF-HD continuous hinges or any FBC approved continuous hinge may be used											
	Pivots	Rixson 195 Pivot set with M19 intermediate pivots may be used											
Auxiliary Hardware	1" diameter and smaller preparations for door position switches, Door position switches that fit in a cutout measuring 1.25" x 4.875"; Securtron EPT, SEPT, and CEPT may be used. Maglocks may be used in addition to the hardware listed above. Viewers with 1" and smaller hole preparation may be used.												

**CECO DOOR PRODUCTS**  
DIVISION OF ASSA ABLOY DOOR GROUP, INC.  
9159 TELECOM DRIVE  
MILAN, TN 38358  
**ASSA ABLOY**  
COMMERCIAL STEEL EXTERIOR DOORS  
FLUSH PAIRS OF DOORS (LMI) - FBC (2023)  
FLORIDA STATEWIDE APPROVAL (FSA FL#16355.1)

REMARKS	DRWN	CHKD	DATE
INIT ISSUE (12-CUI-03g-01)	KL	FLB	06/28/13
FBC UPDATE	RWN	CSL	06/12/15
2017 FBC UPDATE	JEM	FLB	10/03/17
2020 FBC UPDATE	TAE	FLB	12/17/20
2023 FBC (PREV/20-34667)	AMZ	RS	10/18/23

23-68038a

SCALE: NTS UNLESS NOTED

03 OF 10

\*In-Swing Configurations not approved for water infiltration. See Hardware notes for additional Hardware options.

\*\* SUBSTITUTIONS, WITH FBC COMPONENT APPROVALS, MAY BE USED AS LONG AS THE SUBSTITUTIONS ARE WITHIN THE LIMITING DESIGN PARAMETERS OF THIS APPROVAL AND THE COMPONENT APPROVAL.

c:\users\eam\engineering\express\production - documents (1)\projects\23-68038 multiple products 2023 fbc update fl16355\work\drawings & cad\5-2-24 submittal\23-68038a - fl16355.1 - dwg 1.dwg



# CECO DOOR FLUSH PAIRS DOORS

PRODUCTS ILLUSTRATED IN THIS DOCUMENT ARE QUALIFIED FOR LARGE AND SMALL MISSILE IMPACT. LARGE MISSILE IMPACT IS 9 LB 2 X 4 AT 50 FEET PER SECOND OR 350 FT-LBS. (MISSILE LEVEL D) PRODUCT MEETS REQUIREMENTS OF THE HIGH VELOCITY HURRICANE ZONE.

FRANK BENNARDO, PE  
PE# 0046549 CA# 9885

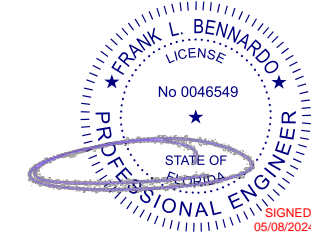

MAY 8, 2024

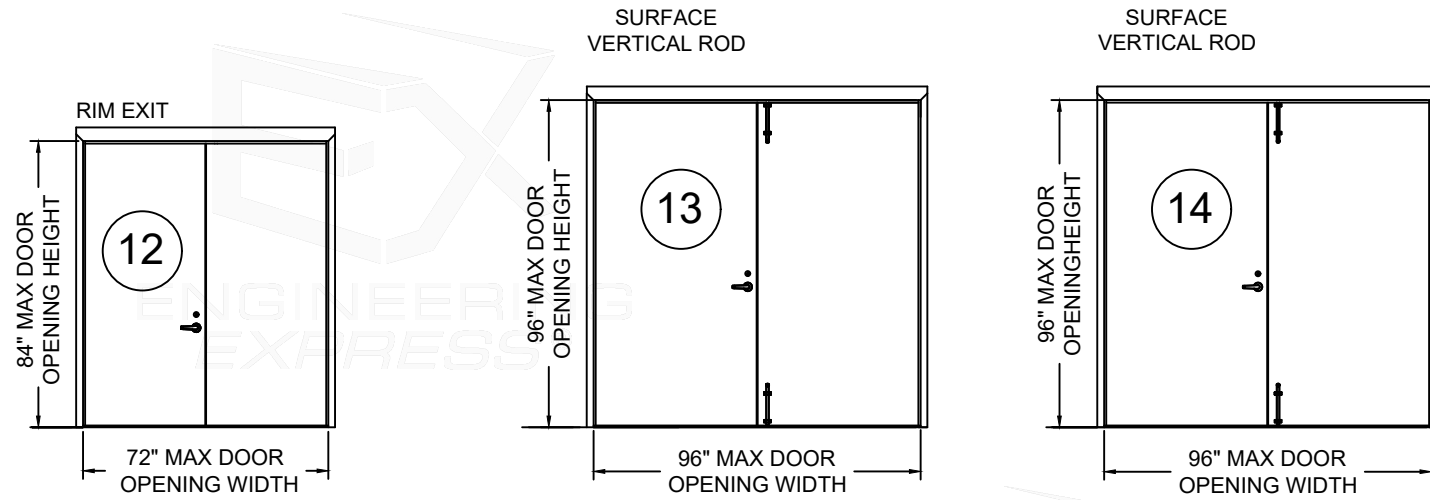

ASSEMBLY 11	
Design Pressure Where Water Infiltration Is NOT Needed	Design Pressure Where Water Infiltration IS Needed
+/-60 PSF	+/-60 PSF

ASSEMBLY 8	
Design Pressure Where Water Infiltration Is NOT Required	Design Pressure Where Water Infiltration IS Required
+/-150 PSF	+/-60 PSF

ASSEMBLY 9	
Design Pressure Where Water Infiltration Is NOT Required	Design Pressure Where Water Infiltration IS Required
+/-150 PSF	+/-60 PSF

Assembly	Door Series	Minimum Door Gauge	Maximum		Door Swing	Latching Hardware Description Active			Latching Hardware Description In-Active				
			Positive	Negative		Width	Height	Type	Brand	Model	Type	Brand	Model
12	Fuego, Imperial, Medallion, Legion, Omega, Regent, Ultra, Versadoor, Trio, Trio-E	18	60	60	72	72	Out Swing	Rim Exit	Corbin Russwin	ED5200S(A) x M107	Rim Exit	Corbin Russwin	ED5200S(A) x M107
									Sargent	HC8800, 12-HC8800		Sargent	HC8800, 12-HC8800
									ASSA ABLOY ACCENTRA	7150(F)WS/7250M(F)WS		ASSA ABLOY ACCENTRA	7150(F)WS/7250M(F)WS
13	Regent, Imperial, Medallion, Legion	14	150	150	96	96	Out Swing	Surface Vertical Rod	Sargent	HC4-8700, 12-HC4-8700	Surface Vertical Rod	Sargent	HC4-8700, 12-HC4-8700
14	Regent, Imperial, Medallion, Legion	14	150	150	96	96	Out Swing	Surface Vertical Rod	Sargent	HC4-8700, 12-HC4-8700	Surface Bolt	Sargent	988
Hinges**	Butt	McKinney 4-1/2" x 4-1/2" 0.134" thick minimum steel hinges or any FBC approved butt hinges may be used. Any SDI member hinge locations may be used.											
	Continuous	Markar FM100, FM200, FM300, FM3500, FM100, FM1111, or HG305; Pemko CFMSLF-HD continuous hinges or any FBC approved continuous hinge may be used											
	Pivots	Rixson 195 Pivot set with M19 intermediate pivots may be used											
Auxiliary Hardware	1" diameter and smaller preparations for door position switches, Door position switches that fit in a cutout measuring 1.25" x 4.875"; Securitron EPT, SEPT, and CEPT may be used. Maglocks may be used in addition to the hardware listed above. Viewers with 1" and smaller hole preparation may be used.												

\*In-Swing Configurations not approved for water infiltration.  
See Hardware Notes for additional Hardware Options

\*In-Swing Configurations not approved for water infiltration.  
See Hardware notes for additional Hardware options.

\*\* SUBSTITUTIONS, WITH FBC COMPONENT APPROVALS, MAY BE USED AS LONG AS THE SUBSTITUTIONS ARE WITHIN THE LIMITING DESIGN PARAMETERS OF THIS APPROVAL AND THE COMPONENT APPROVAL.

FL# 16355.1

**ENGINEERING EXPRESS**  
POSTAL ADDRESS:  
2234 NORTH FEDERAL HWY #7664  
BOCA RATON, FL 33431  
ENGINEERINGEXPRESS.COM

**CECO DOOR PRODUCTS**  
DIVISION OF ASSA ABLOY DOOR GROUP, INC.  
9159 TELECOM DRIVE  
MILAN, TN 38358  
**ASSA ABLOY**  
COMMERCIAL STEEL EXTERIOR DOORS  
FLUSH PAIRS OF DOORS (LMI) - FBC (2023)  
FLORIDA STATEWIDE APPROVAL (FSA FL#16355.1)

REMARKS	DRWN	CHKD	DATE
INIT ISSUE (12-CUI-03g-01)	KL	FLB	06/28/13
FBC UPDATE	RWN	CSL	06/12/15
2017 FBC UPDATE	JEM	FLB	10/03/17
2020 FBC UPDATE	TAE	FLB	12/17/20
2023 FBC (PREV 20-34867)	AMZ	RS	10/18/23

COPYRIGHT ENGINEERING EXPRESS®

23-68038a

SCALE: NTS UNLESS NOTED

04 OF 10

c:\users\eam\engineering\express\production - documents (1)\projects\23-68038 multiple products 2023 fbc update fl16355\work\drawings & cad\5-2-24 submittal\23-68038a - fl16355.1 - dwg 1.dwg

5/8/2024 3:51 PM SAM

# CECO DOOR FLUSH PAIRS DOORS

PRODUCTS ILLUSTRATED IN THIS DOCUMENT ARE QUALIFIED FOR LARGE AND SMALL MISSILE IMPACT. LARGE MISSILE IMPACT IS 9 LB 2 X 4 AT 50 FEET PER SECOND OR 350 FT-LBS. (MISSILE LEVEL D) PRODUCT MEETS REQUIREMENTS OF THE HIGH VELOCITY HURRICANE ZONE.

FRANK BENNARDO, PE  
PE# 0046549 CA# 9885

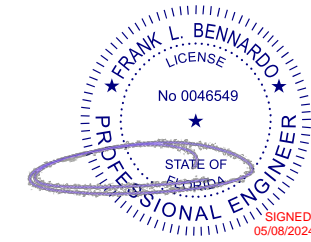

MAY 8, 2024

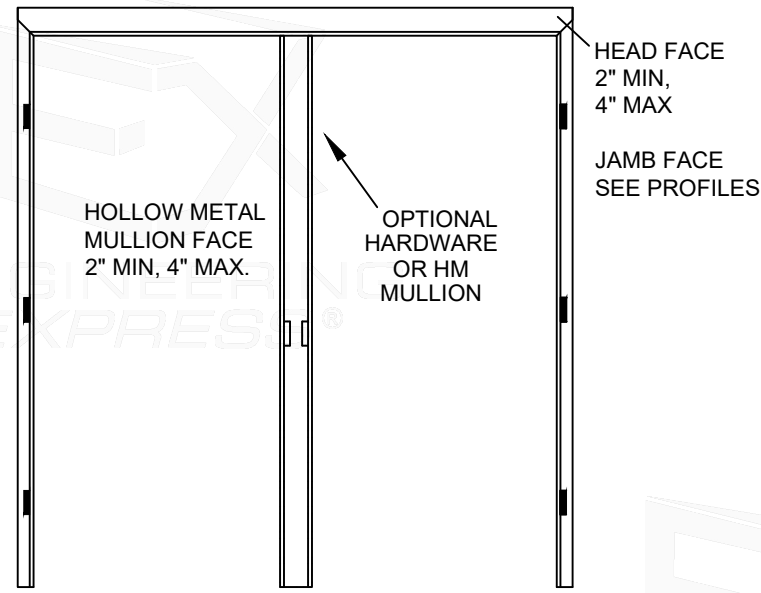

8'0" X 8'0" MAX.  
4" MIN./14" MAX. DEPTH  
KD 16 GA. MIN.  
WELDED 16 GA MIN., 12 GA. MAX.  
MAX DESIGN PRESSURE WITHOUT MULLIONS +/-150 PSF  
MAX DESIGN PRESSURE WITH MULLIONS +/-70 PSF  
FOUR SIDED DOOR FRAME WITH WELDED CORNERS ALSO PERMITTED

## FRAME PROFILES

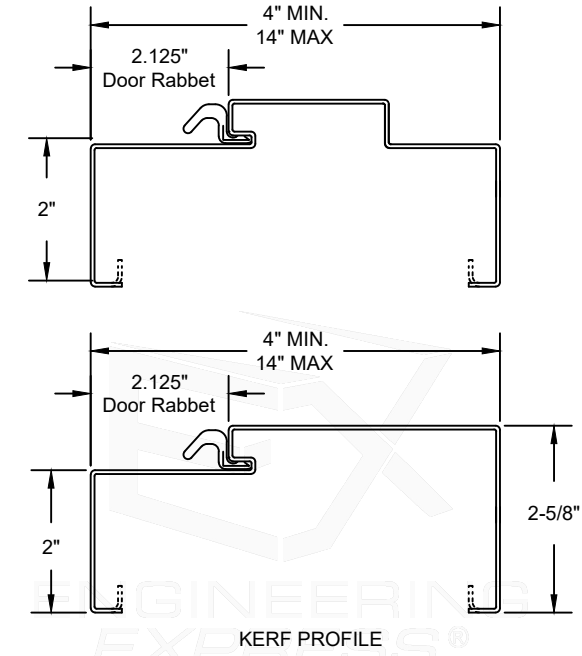
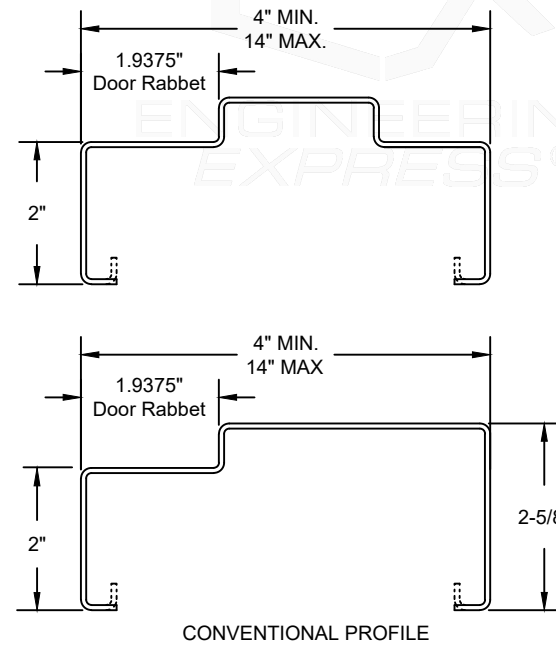

## FRAME CONSTRUCTION OPTIONS

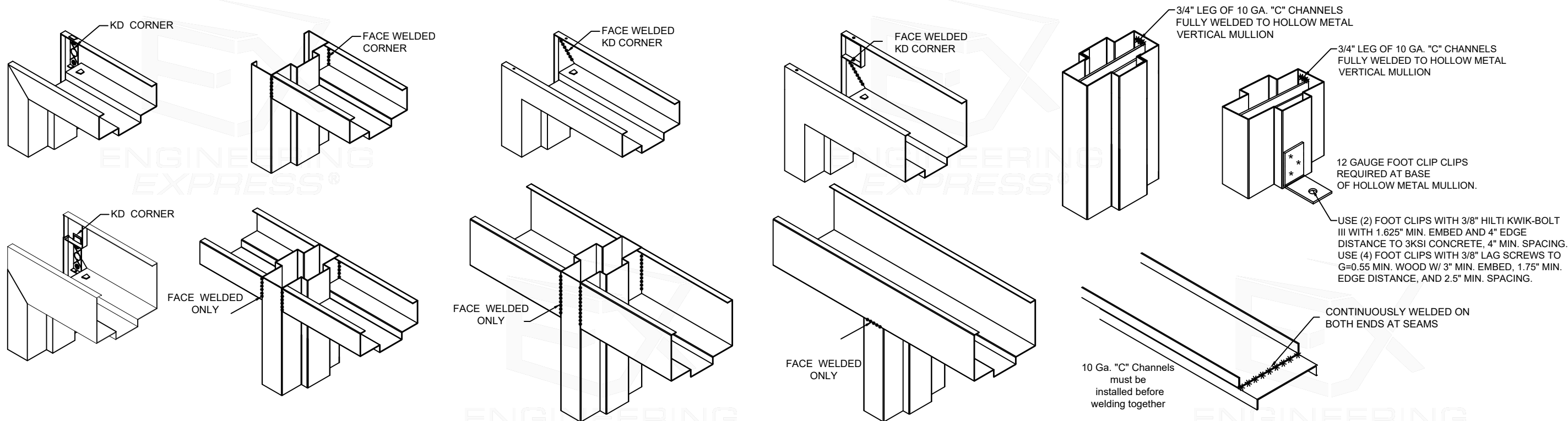

FL# 16355.1

**ENGINEERING EXPRESS**  
POSTAL ADDRESS:  
2234 NORTH FEDERAL HWY #7664  
BOCA RATON, FL 33431  
ENGINEERINGEXPRESS.COM

**CECO DOOR PRODUCTS**  
DIVISION OF ASSA ABLOY DOOR GROUP, INC.  
9159 TELECOM DRIVE  
MILAN, TN 38358  
COMMERCIAL STEEL EXTERIOR DOORS  
FLUSH PAIRS OF DOORS (LMI) - FBC (2023)  
FLORIDA STATEWIDE APPROVAL (FSA FL#16355.1)

REMARKS	DRWN	CHKD	DATE
INIT ISSUE (12-CUI-03g-01)	KL	FLB	06/28/13
FBC UPDATE	RVN	CSL	06/12/15
2017 FBC UPDATE	JEM	FLB	10/03/17
2020 FBC UPDATE	TAE	FLB	12/17/20
2023 FBC (PREV 20-34867)	AMZ	RS	10/18/23

COPYRIGHT ENGINEERING EXPRESS®  
**23-68038a**

SCALE: NTS UNLESS NOTED

05 OF 10

5/8/2024 3:51 PM SAM c:\users\eam\engineering\express\production - documents (1)\projects\23-68038 multiple products 2023 fbc update fl16355\work\drawings & cad\5-2-24 submittal\23-68038a - fl16355.1 - dwg 1.dwg

# CECO DOOR FLUSH PAIRS DOORS

PRODUCTS ILLUSTRATED IN THIS DOCUMENT ARE QUALIFIED FOR LARGE AND SMALL MISSILE IMPACT. LARGE MISSILE IMPACT IS 9 LB 2 X 4 AT 50 FEET PER SECOND OR 350 FT-LBS. (MISSILE LEVEL D) PRODUCT MEETS REQUIREMENTS OF THE HIGH VELOCITY HURRICANE ZONE.

FRANK BENNARDO, PE  
PE# 0046549 CA# 9885

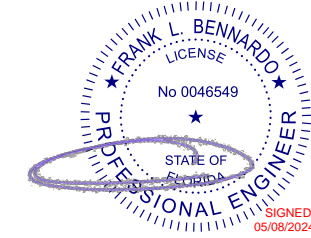

MAY 8, 2024

EXISTING MASONRY OR Poured CONCRETE, 3000 psi MIN.  
WELDED PIPE SPACER OR EWA ANCHOR WITH 3/8" EXPANSION ANCHOR BOLTS USING 3/8" GRADE 5 BOLT  
MINIMUM EDGE DISTANCE = 4.0"  
MAXIMUM SHIM THICKNESS = 0.25"

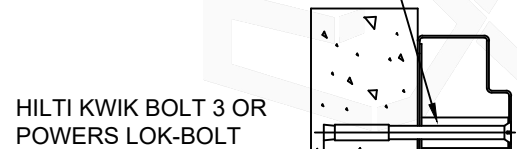

2 3/8" MIN.

16 GA (0.053" MIN) PIPE SPACER ANCHOR

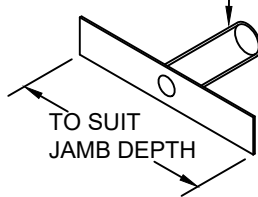

16 GA (0.053" MIN) EWA ANCHOR

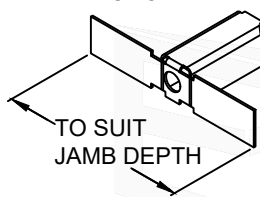

STEEL SHIMS WELDED TO BUILDING STRUCTURE  
WELD HOLLOW METAL FRAME TO SHIM WITH 3/16" WELD, 1" LONG BOTH SIDES OF FRAME

2" X 7" STEEL SHIM PLATE(S), OR TO SUIT FRAME JAMB DEPTH  
MAXIMUM SHIM SPACE 1/4"

MAXIMUM SHIM SPACE 1/4"

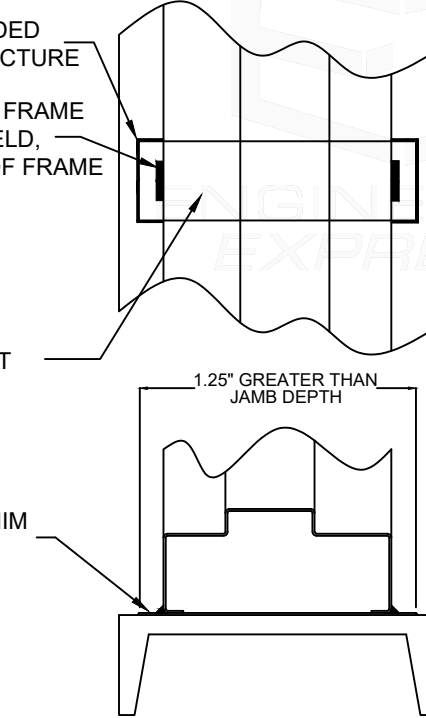

MAXIMUM SHIM THICKNESS 0.25  
CMU BLOCK AND THROAT OF FRAME FILLED WITH 3000 PSI MORTAR

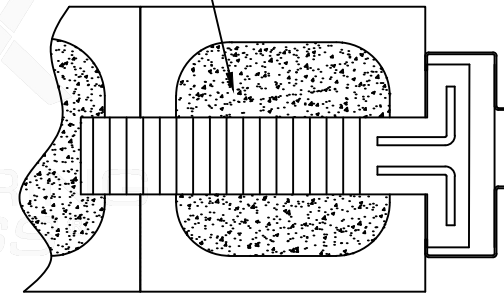

MASONRY WIRE ANCHOR 0.165" DIA. MIN.

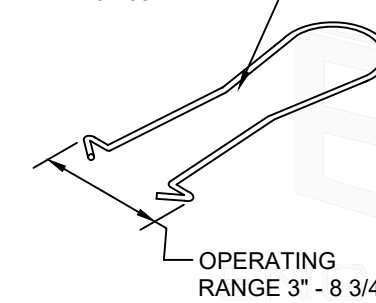

OPERATING RANGE 3" - 8 3/4"

16 GA (0.053" MIN) MASONRY T ANCHOR

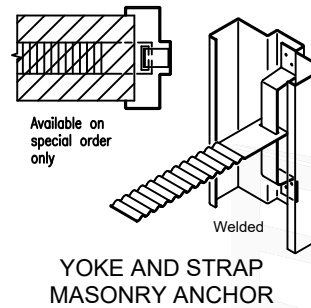
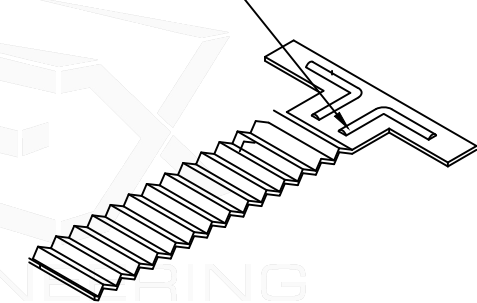

Available on special order only

YOKE AND STRAP MASONRY ANCHOR

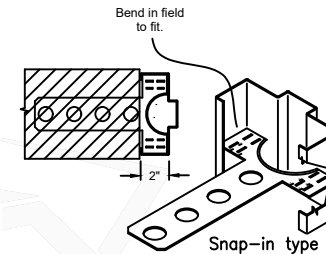

MASONRY "T" ANCHOR (ADJUSTABLE)

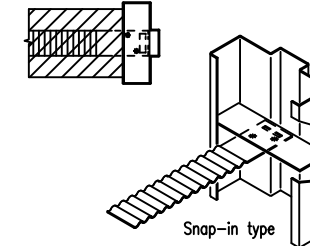

MASONRY "T" ANCHOR

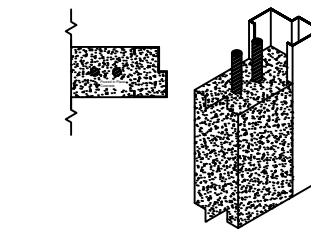

POURED IN PLACE WALL

Expansion Shell Anchors Into 1500 psi Grout filled Concrete Masonry Requirements for Jamb						
Opening Height (inches)	Up to an including 70 psf			150 psf		
	Max. Distance From End of Jamb	Min. Anchor Quantity	Maximum Spacing (inches)	Max. Distance From End of Jamb	Min. Anchor Quantity	Maximum Spacing (inches)
Up to 84"	12	4	19	12	5	15
90	12	4	19	12	6	15
96	12	5	19	12	6	15
Expansion Shell Anchor Requirements for Heads of Paired Frames						
70 psf	2 anchors in the head		150 psf	4 anchors in the head		

Expansion Shell Anchors Into 3000 psi Concrete Requirements for Jamb						
Opening Height (inches)	Up to an including 70 psf			150 psf		
	Max. Distance From End of Jamb	Min. Anchor Quantity	Maximum Spacing (inches)	Max. Distance From End of Jamb	Min. Anchor Quantity	Maximum Spacing (inches)
Up to 84"	12	5	19	12	5	19
90	12	5	19	12	5	19
96	12	6	19	12	6	19
Expansion Shell Anchor Requirements for Heads of Paired Frames						
70 psf	2 anchors in the head		150 psf	4 anchors in the head		

Masonry Strap, Masonry T, Masonry Wire, and Welded to the Building Structure Anchor Requirements for Jamb of Paired Frames						
Opening Height (inches)	Up to an including 70 psf			150 psf		
	Max. Distance From End of Jamb	Min. Anchor Quantity	Maximum Spacing (inches)	Max. Distance From End of Jamb	Min. Anchor Quantity	Maximum Spacing (inches)
Up to 88"	12	4	24	12	4	24
90"	12	5	24	12	5	24
92"-96"	12	5	24	12	5	24
Expansion Shell Anchor Requirements for Heads of Paired Frames						
70 psf	2 anchors in the head		150 psf	4 anchors in the head		
Welded to the Building Structure Anchor Requirements for Heads of Paired Frames						
70 psf	2 anchors in the head		150 psf	2 anchors in the head		

FL# 16355.1

**ENGINEERING EXPRESS**  
POSTAL ADDRESS:  
2234 NORTH FEDERAL HWY #7664  
BOCA RATON, FL 33431  
ENGINEERINGEXPRESS.COM

**CECO DOOR PRODUCTS**  
DIVISION OF ASSA ABLOY DOOR GROUP, INC.  
9159 TELECOM DRIVE  
MILAN, TN 38358  
COMMERCIAL STEEL EXTERIOR DOORS  
FLUSH PAIRS OF DOORS (LMI) - FBC (2023)  
FLORIDA STATEWIDE APPROVAL (FSA FL#16355.1)

REMARKS	DRWN	CHKD	DATE
INIT ISSUE (12-CUI-03g-01)	KL	FLB	06/28/13
FBC UPDATE	RWN	CSL	06/12/15
2017 FBC UPDATE	JEM	FLB	10/03/17
2020 FBC UPDATE	TAE	FLB	12/17/20
2023 FBC (PREV:20-34867)	AMZ	RS	10/18/23

COPYRIGHT ENGINEERING EXPRESS®  
23-68038a

SCALE: NTS UNLESS NOTED

06 OF 10

5/8/2024 3:51 PM SAM c:\users\eam\engineering\express\production - documents (1)\projects\23-68038 multiple products 2023 fbc update fl16355\work\drawings & cad\5-2-24 submittal\23-68038a - fl16355.1 - dwg 1.dwg



# CECO DOOR FLUSH PAIRS DOORS

PRODUCTS ILLUSTRATED IN THIS DOCUMENT ARE QUALIFIED FOR LARGE AND SMALL MISSILE IMPACT. LARGE MISSILE IMPACT IS 9 LB 2 X 4 AT 50 FEET PER SECOND OR 350 FT-LBS. (MISSILE LEVEL D) PRODUCT MEETS REQUIREMENTS OF THE HIGH VELOCITY HURRICANE ZONE.

FRANK BENNARDO, PE  
PE# 0046549 CA# 9885

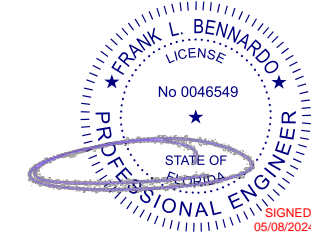

MAY 8, 2024

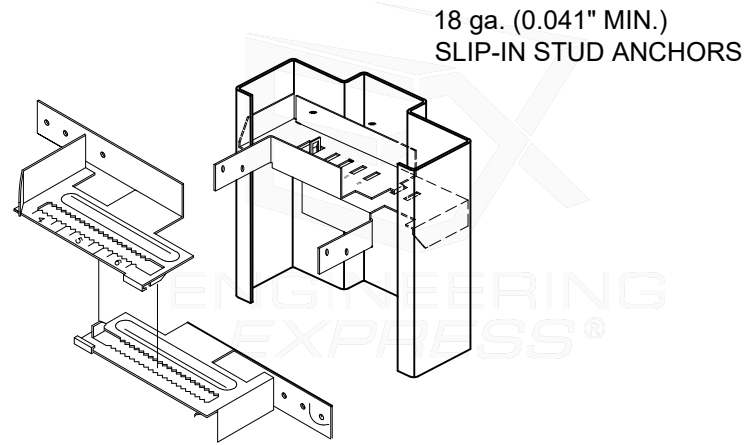

18 ga. (0.041" MIN.)  
SLIP-IN STUD ANCHORS

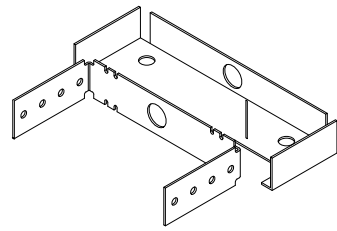

SLIP-IN STUD ANCHOR WELDEED TO  
FRAME CONNECT TO STEEL  
WITH #8 X 1" GRADE 5 SHEET METAL SCREW;  
4 SCREWS REQUIRED PER ANCHOR;  
MIN EDGE DISTANCE - 0.328"

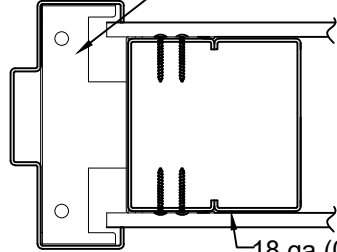

18 ga (0.041" min.)  
STEEL STUDS

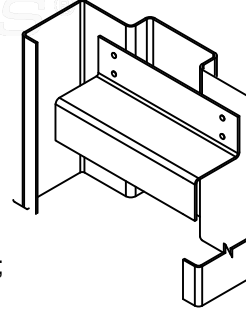

#14 x 1" GRADE 5 SHEET METAL SCREW;  
2 SCREWS REQUIRED  
PER ANCHOR LOCATION;

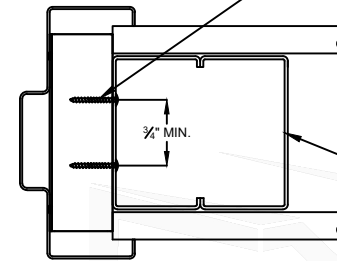

18 ga (0.041" min.)  
STEEL STUDS

WELDED WOOD STUD ANCHOR  
WITH #8 X 1" GRADE 5 SHEET METAL SCREW;  
4 SCREWS REQUIRED PER ANCHOR;  
MIN EMBEDMENT = 1" MIN EDGE DISTANCE = 0.524"

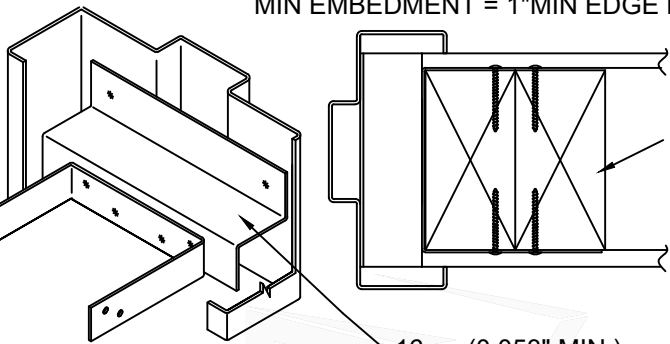

16 ga (0.053" MIN.)  
WOOD STUD ANCHOR

WOOD STUD

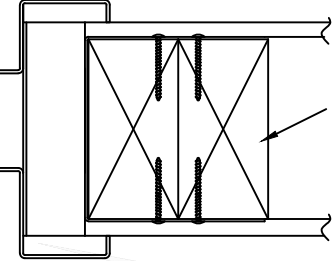

WELED WOOD STUD ANCHOR  
WITH #8 X 1" GRADE 5 SHEET METAL SCREW;  
4 SCREWS REQUIRED PER ANCHOR;  
MIN EMBEDMENT = 1" MIN EDGE DISTANCE = 0.524

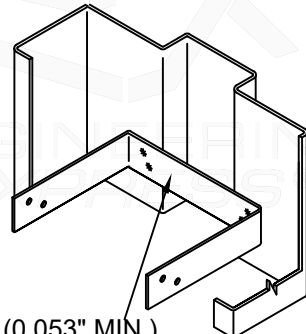

16 ga (0.053" MIN.)  
WOOD STUD ANCHOR

WOOD STUD

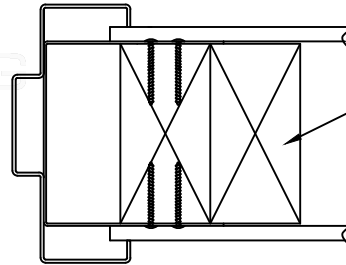

16 GA (0.053" MIN)  
PIPE SPACER ANCHOR

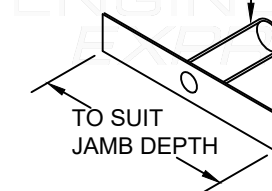

TO SUIT  
JAMB DEPTH

16 GA (0.053" MIN)  
EWA ANCHOR

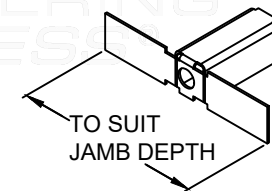

TO SUIT  
JAMB DEPTH

WELDED PIPE SPACER OR EWA ANCHOR  
WITH 3/8" WOOD SCREW OR LAG BOLT  
MINIMUM EDGE DISTANCE = 1.75"  
MAXIMUM SHIM THICKNESS = 0.25"

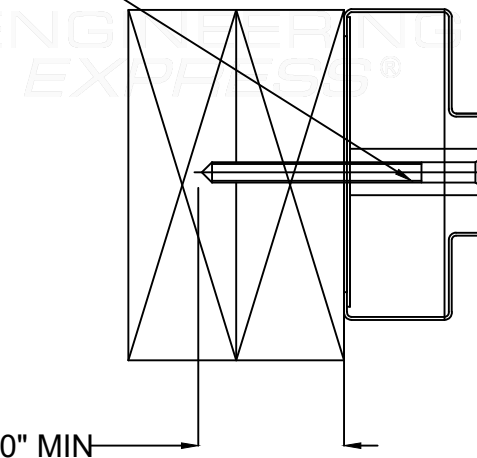

3.0" MIN

WELDED PIPE SPACER OR EWA ANCHOR  
WITH 3/8" (GRADE 2 MIN.) TAP-IN BOLT  
WITH 3 PINCHES PASSED THE THREAD  
PLANE. MINIMUM EDGE DISTANCE = 1.75"  
MAXIMUM SHIM THICKNESS = 0.25"

1/4" THK. MIN. A36 MIN.  
STEEL SUBSTRATE

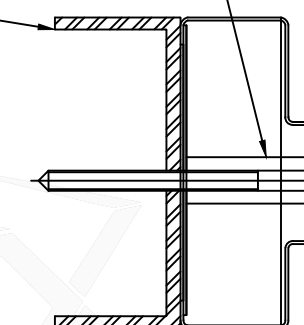

Stud Anchor Requirements for Paired Frame Jamb						
Opening Height (inches)	Up to an including 70 psf			150 psf		
	Max. Distance From End of Jamb	Min. Anchor Quantity	Maximum Spacing (inches)	Max. Distance From End of Jamb	Min. Anchor Quantity	Maximum Spacing (inches)
Up to 88"	12	4	21	12	6	12
90"	12	5	21	12	7	12
92"-96"	12	5	21	12	7	12
Stud Anchor Requirements for Heads of Paired Frames						
70 psf	4 anchors in the head		150 psf	8 anchors in the head		

FL# 16355.1



POSTAL ADDRESS:  
2234 NORTH FEDERAL HWY #7664  
BOCA RATON, FL 33431  
ENGINEERINGEXPRESS.COM

CECO DOOR PRODUCTS  
DIVISION OF ASSA ABLLOY DOOR GROUP, INC.  
9159 TELECOM DRIVE  
MILAN, TN 38358



COMMERCIAL STEEL EXTERIOR DOORS  
FLUSH PAIRS OF DOORS (LMI) - FBC (2023)  
FLORIDA STATEWIDE APPROVAL (FSA FL#16355.1)

REMARKS	DRWN	CHKD	DATE
INIT ISSUE (12-CUI-03g-01)	KL	FLB	06/28/13
FBC UPDATE	RWN	CSL	06/12/15
2017 FBC UPDATE	JEM	FLB	10/03/17
2020 FBC UPDATE	TAE	FLB	12/17/20
2023 FBC UPDATE (PREV:20-34867)	AMZ	RS	10/18/23

COPYRIGHT ENGINEERING EXPRESS®

23-68038a

SCALE: NTS UNLESS NOTED

07 OF 10

5/8/2024 3:51 PM SAM c:\users\eam\engineering\express\production - documents (1)\projects\23-68038 multiple products 2023 fbc update fl16355\work\drawings & cad\5-2-24 submittal\23-68038a - fl16355.1 - dwg 1.dwg

# CECO DOOR FLUSH PAIRS DOORS

PRODUCTS ILLUSTRATED IN THIS DOCUMENT ARE QUALIFIED FOR LARGE AND SMALL MISSILE IMPACT. LARGE MISSILE IMPACT IS 9 LB 2 X 4 AT 50 FEET PER SECOND OR 350 FT-LBS. (MISSILE LEVEL D) PRODUCT MEETS REQUIREMENTS OF THE HIGH VELOCITY HURRICANE ZONE.

PEMKO WEATHERSTRIP USED ON CECO DOORS AND FRAMES WHERE WATER INFILTRATION IS NOT REQUIRED.

FRANK BENNARDO, PE  
PE# 0046549 CA# 9885

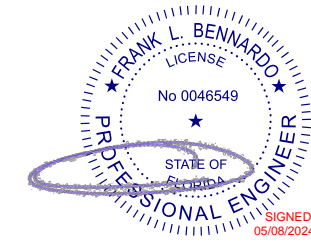

MAY 8, 2024

FL# 16355.1

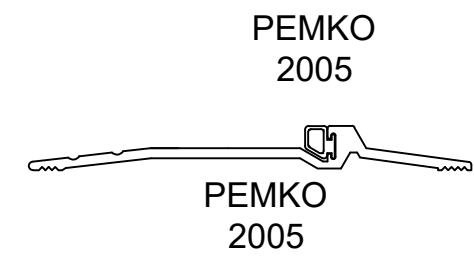
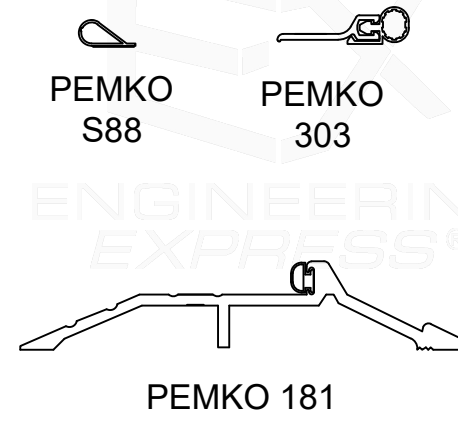
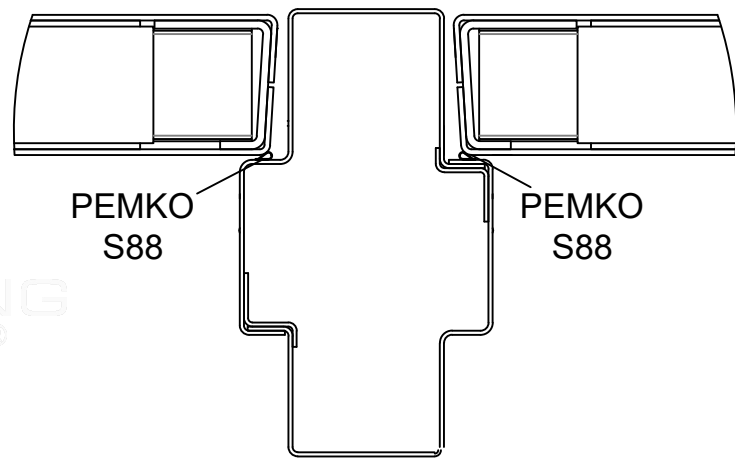
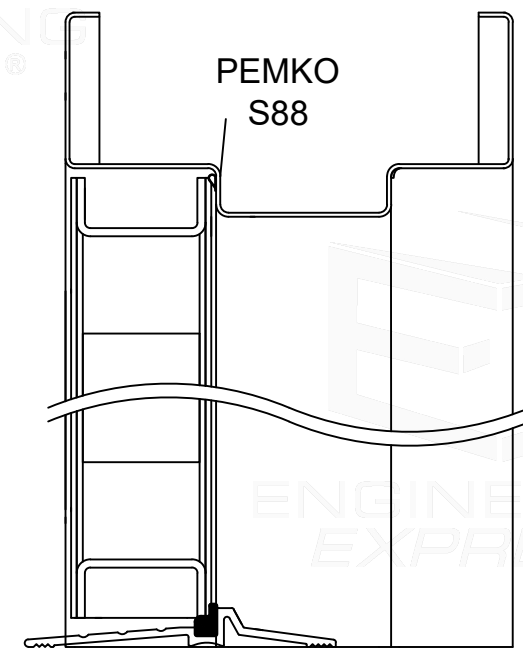
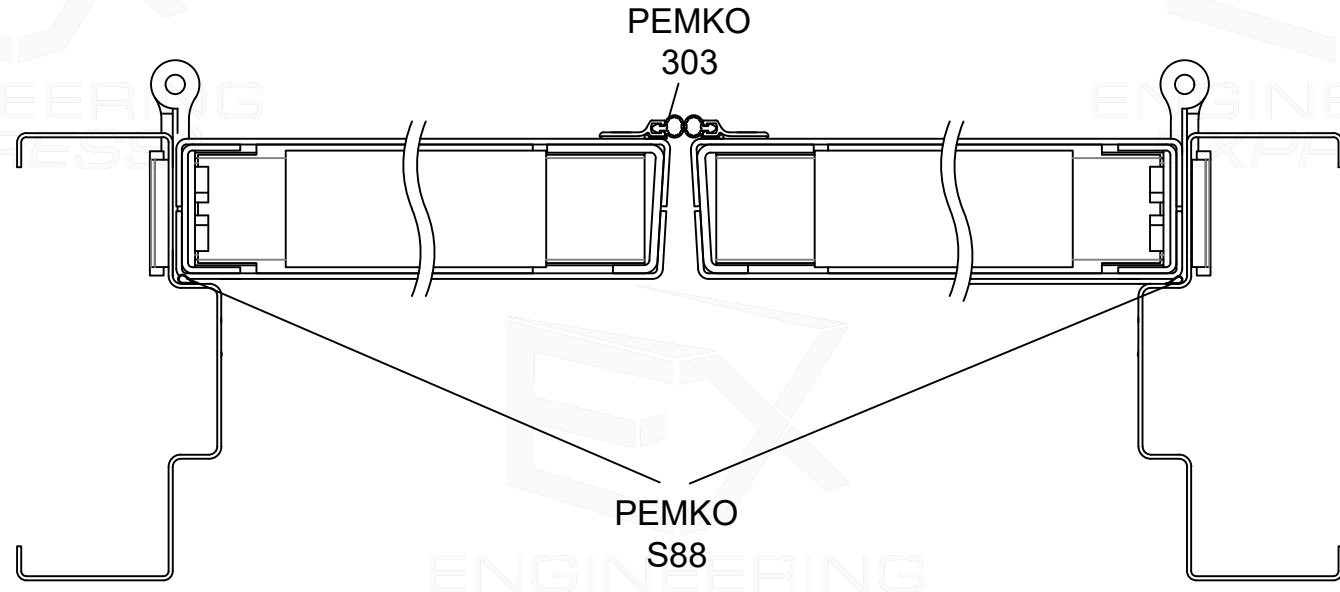

**ENGINEERING EXPRESS**  
 POSTAL ADDRESS:  
 2234 NORTH FEDERAL HWY #7664  
 BOCA RATON, FL 33431  
 ENGINEERINGEXPRESS.COM

**CECO DOOR PRODUCTS**  
 DIVISION OF ASSA ABLOY DOOR GROUP, INC.  
 9159 TELECOM DRIVE  
 MILAN, TN 38358  
 COMMERCIAL STEEL EXTERIOR DOORS  
 FLUSH PAIRS OF DOORS (LMI) - FBC (2023)  
 FLORIDA STATEWIDE APPROVAL (FSA FL#16355.1)

REMARKS	DRWN	CHKD	DATE
INIT ISSUE (12-CUI-03g-01)	KL	FLB	06/28/13
FBC UPDATE	RWN	CSL	06/12/15
2017 FBC UPDATE	JEM	FLB	10/03/17
2020 FBC UPDATE	TAE	FLB	12/17/20
2023 FBC (PREV 20-34867)	AMZ	RS	10/18/23

23-68038a

SCALE: NTS UNLESS NOTED

08 OF 10

5/8/2024 3:51 PM SAM c:\users\sam\engineering\express\production - documents (1)\projects\23-68038 multiple products 2023 fbc update fl16355\work\drawings & cad\5-2-24 submittal\23-68038a - fl16355.1 - dwg 1.dwg



# CECO DOOR FLUSH PAIRS DOORS

PRODUCTS ILLUSTRATED IN THIS DOCUMENT ARE QUALIFIED FOR LARGE AND SMALL MISSILE IMPACT. LARGE MISSILE IMPACT IS 9 LB 2 X 4 AT 50 FEET PER SECOND OR 350 FT-LBS. (MISSILE LEVEL D) PRODUCT MEETS REQUIREMENTS OF THE HIGH VELOCITY HURRICANE ZONE.

PEMKO WEATHERSTRIP USED ON CECO DOORS AND FRAMES WHERE WATER INFILTRATION IS REQUIRED.

FRANK BENNARDO, PE  
PE# 0046549 CA# 9885

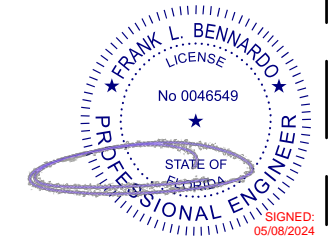

MAY 8, 2024

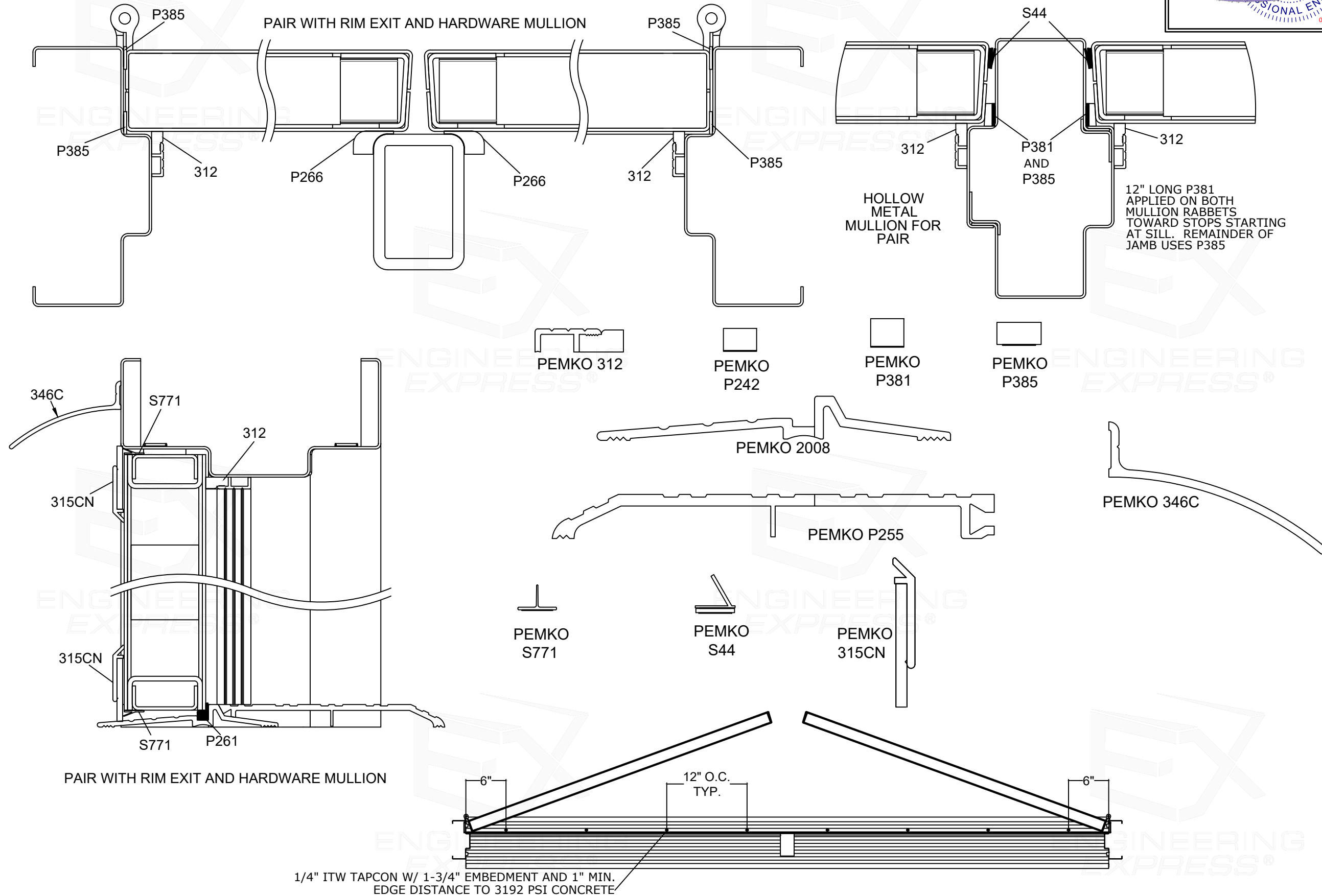

FL# 16355.1

**ENGINEERING EXPRESS**  
 POSTAL ADDRESS:  
 2234 NORTH FEDERAL HWY #7664  
 BOCA RATON, FL 33431  
 ENGINEERINGEXPRESS.COM

**CECO DOOR PRODUCTS**  
 DIVISION OF ASSA ABLOY DOOR GROUP, INC.  
 9159 TELECOM DRIVE  
 MILAN, TN 38358  
 COMMERCIAL STEEL EXTERIOR DOORS  
 FLUSH PAIRS OF DOORS (LMI) - FBC (2023)  
 FLORIDA STATEWIDE APPROVAL (FSA FL#16355.1)

REMARKS	DRWN	CHKD	DATE
INIT ISSUE (12-CUI-03g-01)	KL	FLB	06/28/13
FBC UPDATE	RWN	CSL	06/12/15
2017 FBC UPDATE	JEM	FLB	10/03/17
2020 FBC UPDATE	TAE	FLB	12/17/20
2023 FBC (PREV 20-34867)	AMZ	RS	10/18/23

23-68038a

SCALE: NTS UNLESS NOTED

09 OF 10

c:\users\eam\engineering\express\production - documents (1)\projects\23-68038 multiple products 2023 fbc update fl16355\work\drawings & cad\5-2-24 submittal\23-68038a - fl16355.1 - dwg 1.dwg  
 5/8/2024 3:51 PM SAM

# HARDWARE NOTES

## CORBIN RUSSWIN

THE ED5200(S)A RIM EXIT AND THE ED5470(B) X M107 SURFACE VERTICAL ROD MAYBE SUFFIXED BY MER. MAY USE M94 WITH ANY COMBINATION OF THE M61, M92, M93, OR M1 SUFFIXES.

THE ED5200(S)A X M107 RIM EXIT AND THE ED5470(B) X M107 SURFACE VERTICAL ROD MAY INCLUDE 900 SERIES TRIMS 9600, 9700, 9800 SERIES ACCESS CONTROL TRIMS OR THE 9900 SERIES ELECTRIFIED TRIMS.

THE MP9800 (A/B) X M107 SERIES CONCEALED MULTI-POINT LOCK MAY INCLUDE THE OPTIONS: M91, M92, M93, 903, 904, IN, INB, SE.

USE CRFE722A, CRFE708A OR CRWS700AKM HARDWARE MULLION WITH THE ED5200(S)A / ED4200(S)A X M107 RIM EXIT

ON PAIRS OF DOORS, ONE LEAF OF THE PAIR UTILIZING WITH THE ED5470(B) X M107 SURFACE VERTICAL ROD OR MP9800 (A/B) X M107 SERIES CONCEALED MULTI-POINT LOCK MAY BE REPLACED WITH TWO 988CR SURFACE BOLTS. THE LOCAL BUILDING OFFICIAL MUST APPROVE THIS CONFIGURATION OF HARDWARE FOR USE IN A MEANS OF EGRESS.

THE ML2000 SERIES MORTISE LOCKS, SERIES CLX3300 SERIES CYLINDRICAL LOCKS, ED5200(S)A X M107 RIM EXIT, AND ED5470(B) X M107 SURFACE VERTICAL ROD MAY BE PREFIXED IN-IP, IN-IPS, IN-CP, IN-IP-MB, IN-IP-MW, IN-IPS-MB, IN-IPS-MW, IN-CP-MP, AND IN-CP-MW.

THE ML2000 SERIES MORTISE LOCKS, SERIES CLX3300 SERIES CYLINDRICAL LOCKS, ED5200(S)A X M107 RIM EXIT MAY BE PREFIXED PIP1-IPSKM, PWI1-IPSKM, PIP1-CPKM, PWI1-CPKM, PIP1-IPSM, PWI1-IPSM, PIP1-CPM, AND PWI1-CPM.

THE IN 120 ACCESS CONTROL MAY BE USED WITH CLX3300 CYLINDRICAL LOCK OR ML2000 MORTISE LOCK.

## HES

THE 1006 SERIES ELECTRIC STRIKE MAYBE USED ON 4'0" X 8'0" AND SMALLER SINGLE OR 8'0" X 8'0" AND SMALLER PAIRS OUT SWINGING DOORS OF 70 PSF OR LESS.

THE 9600 SERIES ELECTRIC STRIKE MAY BE USED WITH THE SARGENT HC8800 SERIES RIM EXIT AT DESIGN PRESSURES OF 70 PSF OR LESS.

THE 9700 SERIES ELECTRIC STRIKE MAY BE USED WITH THE CORBIN RUSSWIN ED5200(S)A AND THE YALE 7150(F)WS / 7250M(F)WS RIM EXITS AT DESIGN PRESSURES OF 70 PSF OR LESS.

SECURITRON 1500 / 1500E STRIKE MAY BE USED ON 3'0" X 7'0" AND SMALLER SINGLE OUT SWINGING ASSEMBLIES WITH MORTISE LOCKS AND LATCH BOLT ONLY AT DESIGN PRESSURES OF 60 PSF OR LESS.

SECURITRON 1600 / 1600E STRIKE MAY BE USED ON 4'0" X 8'0" AND SMALLER SINGLE OUT SWINGING ASSEMBLIES WITH MORTISE LOCKS WITH LATCH BOLT AND DEAD BOLT OF 70 PSF AND LESS.

## SARGENT

THE HC8800 SERIES RIM EXIT, WS 8800 SERIES RIM EXIT, AND WS-8900 SERIES MORTISE EXIT MAYBE PREFIXED 53, 55, 55-56, 56, 57, 58, AWE, B, BT, ET, KP, LK, LU, M1, N1, N2, PA, PK, P1, P2, IPSKM, CPKM, IPSM, CPM, IM, IKM, PRX, S1, S2, S3, IA, IK, IN, TK, TL, TP AND TU.

USE HC980, 12-HC980, HCL980, 12-HCL980 HARDWARE MULLION WITH THE HC8800 SERIES RIM EXIT.

SERIES HT-56- CAN BE USED SAME AS THE 53-56- ON THE 80 SERIES DEVICES. EXCEPTIONS INCLUDE THE FOLLOWING PREFIXES EITHER USED ALONE OR IN COMBINATION: 53-, 55-, 57-, 58-, 59- AND AL. ALL 80 SERIES EMPLOYING HIO TECHNOLOGY AND THE 55 OPTION ARE DESIGNATED HT-55-.

THE MD8600 SERIES CONCEALED VERTICAL ROD EXIT AND 7000 SERIES CONCEALED MULTI-POINT LOCK MAY BE PREFIXED 53, 55, 56, 58, 59, BT & ET.

ON PAIRS OF DOORS, ONE LEAF OF THE PAIR UTILIZING WITH THE MD8600 SERIES CONCEALED VERTICAL ROD EXIT, 7000 CONCEALED MULTI-POINT LOCK OR HC4-8700 / HC-8700 SURFACE VERTICAL ROD MAY BE REPLACED WITH TWO 988CR SURFACE BOLTS. THE LOCAL BUILDING OFFICIAL MUST APPROVE THIS CONFIGURATION OF HARDWARE FOR USE IN A MEANS OF EGRESS.

THE IN 10 ACCESS CONTROL MAY BE USED WITH THE 10X CYLINDRICAL LOCK AND THE 8200 AND THE R8200 MORTISE LOCKS

## BUTT HINGES

- 2 HINGES ARE REQUIRED FOR DOORS UP TO AND INCLUDING 60 INCHES IN HEIGHT
- 3 HINGES ARE REQUIRED FOR DOORS OVER 60 INCHES IN HEIGHT AND UP TO AND INCLUDING 90" IN HEIGHT
- 4 HINGES ARE REQUIRED FOR DOORS OVER 90 INCHES IN HEIGHT AND UP TO AND INCLUDING 96" IN HEIGHT

ADDITIONAL HINGES BEYOND THOSE REQUIRED MAY BE REQUIRED.

## ASSA ABLOY ACCENTRA

7150(F)WS / 7250M(F)WS RIM EXIT AND 7170(F)WS SURFACE VERTICAL ROD MAY BE SUFFIXED WITH ANY COMBINATION OF A, B, O, OR S.

USE M200FWS OR KRM200FWS MULLION WITH THE 7150(F)WS / 7250M(F)WS RIM EXIT.

ON PAIRS OF DOORS, ONE LEAF OF THE PAIR UTILIZING WITH THE 7170(F)WS SURFACE VERTICAL ROD MAY BE REPLACED WITH TWO 988CR SURFACE BOLTS. THE LOCAL BUILDING OFFICIAL MUST APPROVE THIS CONFIGURATION OF HARDWARE FOR USE IN A MEANS OF EGRESS

ACCESS CONTROL MAY BE USED.

## SECURITRON

THE MUNL MAY BE USED ON 60 PSF RATED SINGLE 3'0" X 7'0" ASSEMBLIES WITH A MORTISE CORBIN RUSSWIN ML2000, SARGENT 7800/8200/R8200, OR ASSA ABLOY ACCENTRA 8800 MORTISE LOCK. THE UNL MAY BE USED ON 60 PSF RATED SINGLE 3'0" X 7'0" ASSEMBLIES WITH A CORBIN RUSSWIN CL3100 / CLX3300 / CL3800, SARGENT 6500 / 7 / 10X, OR ASSA ABLOY ACENTRA / 5300LN / 5400CK / 5400LN CYLINDRICAL LOCKS.

THE HARDWARE MODELS BELOW MAY ALSO BE USED FOR THE SIZES AND DESIGN PRESSURES INDICATED. CONCEALED VERTICAL RODS AND SURFACE VERTICAL RODS MAY BE USED IN A PAIRED CONFIGURATION. RIM EXITS MAY BE USED IN PAIRED CONFIGURATION WITH A HURRICANE RATED MULLION					
DESIGN PRESSURE	SIZE	HARDWARE TYPE	MIN, GAUGE	CORBIN RUSSWIN	SARGENT
60	3'-0" x 7'-0"	MORTISE EXIT	18	PED5600 M107 PED5600 A M107*	WS-PE8900 WS-12-PE8900*
60	3'-0" x 7'-0"	RIM EXIT	18	PED5200 HC PED5200 A HC* PED5200 M107 PED5200 A M107*	HC-PE8800 12-HC-PE8800* WS-PE8800 WS-12-PE8800*
60	3'-0" x 8'-0" SINGLE 6'-0" x 8'-0" PAIR	CONCEALED VERTICAL ROD	16	PED5800 MD 107 PED5800 MD HC	HC-MD-PE8600 WS-MD-PE8600
60	3'-0" x 8'-0" SINGLE 6'-0" x 8'-0" PAIR	RIM EXIT	16	PED5200 HC PED5200 A HC*	HC-PE8800 12-HC-PE8800*
60	3'-0" x 8'-0" SINGLE 6'-0" x 8'-0" PAIR	SURFACE VERTICAL ROD	16	PED5400 HC	HC-PE8700
70	4'-0" x 8'-0" SINGLE 8'-0" x 8'-0" PAIR	CONCEALED VERTICAL ROD	16	PED5800 MD 107 PED5800 MD HC	HC-MD-PE8600 WS-ME-PE8600
70	4'-0" x 8'-0" SINGLE 8'-0" x 8'-0" PAIR	RIM EXIT	16	PED5200 HC PED5200A HC*	HC-PE8800
70	4'-0" x 8'-0" SINGLE 8'-0" x 8'-0" PAIR	SURFACE VERTICAL ROD	16	PED5400 HC	HC-PE8700
150	4'-0" x 8'-0" SINGLE 8'-0" x 8'-0" PAIR	SURFACE VERTICAL ROD	14	PED5400 HC4 PED5400 A HC4*	HC4-8700 12-HC4-PE8700*

\*INDICATED A FIRE RATED EXIT HARDWARE MAY BE USED ON A SINGLE DOOR

FRANK BENNARDO, PE  
PE# 0046549 CA# 9885

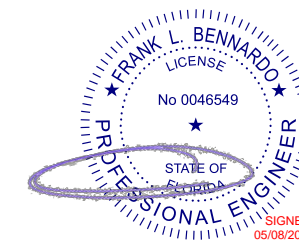

MAY 8, 2024

FL# 16355.1

**ENGINEERING EXPRESS**  
POSTAL ADDRESS:  
2234 NORTH FEDERAL HWY #7664  
BOCA RATON, FL 33431  
ENGINEERINGEXPRESS.COM

**CECO DOOR PRODUCTS**  
DIVISION OF ASSA ABLOY DOOR GROUP, INC.  
9159 TELECOM DRIVE  
MILAN, TN 38358  
**ASSA ABLOY**  
COMMERCIAL STEEL EXTERIOR DOORS  
FLUSH PAIRS OF DOORS (LMI) - FBC (2023)  
FLORIDA STATEWIDE APPROVAL (FSA FL#16355.1)

REMARKS	DRWN	CHKD	DATE
INIT ISSUE (12-CUI-03g-01)	KL	FLB	06/28/13
FBC UPDATE	RWN	CSL	06/12/15
2017 FBC UPDATE	JEM	FLB	10/03/17
2020 FBC UPDATE	TAE	FLB	12/17/20
2023 FBC (REV.20-34867)	AMZ	RS	10/18/23

COPYRIGHT ENGINEERING EXPRESS®

23-68038a

SCALE: NTS UNLESS NOTED

10 OF 10

c:\users\eam\engineering\express\production - documents (1)\projects\23-68038 multiple products 2023 fbc update fl16355\work\drawings & cad\5-2-24 submittal\23-68038a - fl16355.1 - dwg 1.dwg 5/8/2024 3:51 PM SAM